



InventorCAM

InventorCAM Newsletter May 2009

Dear Wolfgang,

We are pleased to announce the release of InventorCAM2010. InventorCAM2010, the leading integrated CAM solution for Inventor, is ready to power up Inventor 2010 to be the best completely integrated CAD/CAM solution for Inventor users. With a synchronized release of InventorCAM 2010 to coincide with the release of Inventor2010 in April 2009, users will experience a new level of CAD/CAM, united into one extremely powerful package. InventorCAM is considered to be the industry standard for an Integrated CAM solution for Inventor due to its seamless integration, associativity, power and unmatched user interface's consistency and flow with Inventor.

We have over 15 years of experience in integration architecture development. InventorCAM's feel and functionality work as seamlessly with Inventor as possible. The entire program dedicates itself to a "feel right" user experience. The user must be able to feel comfortable and use his existing knowledge of Inventor to quickly, easily and efficiently be productive making tool paths from the very beginning. To the user, we have simply enhanced their CAD system to do very high-level CNC programming.

Dear reader, [Please click here to view the full InventorCAM2010 release.](#)

Emil Somekh
Managing Director
SolidCAM Ltd.

Phoenix machining success story



People often wonder what the secret is to running a successful company. In one company, Phoenix Machine in Columbia Falls, MT, www.boltactions.net, success is no secret. "Give customers choices to get exactly what they want, when they want it, and with quality and performance that surpasses their expectations", says

Glen Harrison, founder and president of Phoenix Machine that manufactures bolt actions for custom rifle builders all over the world. Glen has a personal philosophy that enables him to deliver these customer-centric services that are the key to Phoenix Machine's Success. Glen's personal philosophy is that, "anything can be improved upon". Glen explains, "We continually challenge ourselves to ensure our customers receive only our very best effort. They have our assurances that we have a deep commitment to excellence in design, process and manufacturing."

About a year and half ago, Glen decide to purchase InventorCAM. "With my previous experience using AutoCode inside AutoCAD, it seemed like a natural choice to go with a CAM program that runs right inside Inventor like InventorCAM. The lead-time to learn the program really concerned me at first, as I did not have the time to go to classes. However, the learning curve was not steep at all. In fact, InventorCAM was extremely easy to learn. Especially with my Inventor experience, InventorCAM seemed like a natural extension of Inventor to do our CAM. I was actually generating code the first week, and this is on our five axis CNC machine. Not only was it easy to learn, but the programming time as well as the machining time it saved us was astonishing. We could finally take advantage of our 60-tool CNC machine and eliminate having to change tools between operations. "The difference before and after InventorCAM is like night and day in terms of productivity".

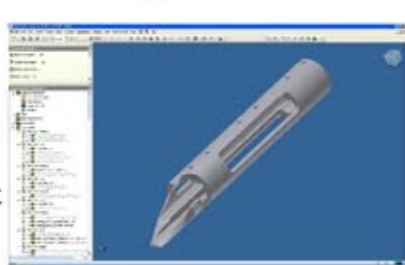

[To view full story please click here.](#)

InventorCAM - the best CAM for Inventor

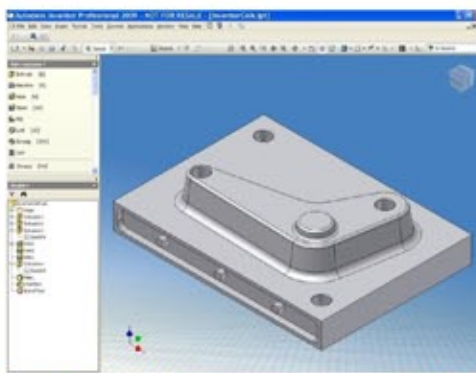

The leading UK reseller of Autodesk Inventor, Midas Technology Ltd., and SolidCAM UK hosted a series of hands-on Inventor+InventorCAM seminars for the UK manufacturing industry. Inventor is the flagship 3D design software from Autodesk and InventorCAM is the fully integrated Autodesk Certified product

for complete CNC machining right inside Inventor. InventorCAM provides seamless, single-window integration with the Inventor model. Powerful, easy-to-use and generating efficient, optimized G-Code, InventorCAM is the standard for integrated CAM in Inventor.

In a single day, participants were introduced to the world of integrated 3D design and manufacturing with Inventor and InventorCAM. In the morning, they designed a complete 3D part with Inventor and in the afternoon they continued the process by using InventorCAM's CNC programming capabilities on their models to quickly and easily generate a CNC program from right inside Inventor.

Seminar Agenda:

- Sketching of the part with Inventor
- Generation of the 3D part with Inventor
- Integrated user Interface Inventor/InventorCAM
- Definition of the manufacturing process with InventorCAM
- Simulation of the manufacturing process with InventorCAM
- Generation of the CNC program

More than 20 participants attended the 3 seminars, which took place in 3 different locations:

- March 4th, 2009 in Whiteley
- March 5th 2009 in Horley
- March 31rd 2009 in Barnsley

Worldview technologies launches InventorCAM in Johannesburg, South Africa



Worldview Technologies has recently announced that it is now the authorized distributor for the InventorCAM software suite, the CAM solution totally integrated in Autodesk Inventor.

Based in Midrand, Gauteng, South Africa, the rapidly growing WorldView Technologies is the authorized distributor for sub-Saharan Africa of Autodesk design software. WorldView Technologies manages the flow of Autodesk products to channel partners and resellers throughout the region. Offering their own complete solution for channel partners, WorldView provides them with market and sales support as well as business and technical training. The addition of InventorCAM to their product line is a natural extension of their commitment to offering a "one stop" complete Design to Manufacturing Solution.

WorldView technologies launched InventorCAM in Johannesburg, South Africa, on January 22nd, 2009, at Emperors palace. During the event, the full integration and associativity of InventorCAM in Inventor was shown, demonstrating the strong advantages of seamless integration. This true uniqueness allows the optimal use of the manufacturing functionality in 2.5D Milling, 3D Milling, High-Speed Machining, Multi-sided Indexial 4/5 axes Milling, Simultaneous 5 axes Milling, Turning, Turn-Mill up to 5-axes and Wire EDM, all the while working directly inside the Inventor environment. Both experienced Inventor users as well those new to CAD/CAM were extremely impressed by the ease of use and the powerful functionality of the integrated CAD/CAM system.

For more information regarding InventorCAM in Sub Saharan Africa please do not hesitate to contact Rene Winters; renew@worldsview.co.za.